

TYPICAL INDICATOR ORDERING EXAMPLE

UB 01 K W03 5C — JC

Mounting Types

PCB Mounting

| | |
|---------------------------|--------------------------------|
| 01 | Square |
| 03 | Rectangular |
| * Snap-in Mounting | |
| 04 | Square |
| 06 | Rectangular |
| 06B | Rectangular with Side Barriers |

* Standard with Solder Lug terminals

Housing

| | |
|---|-------|
| K | Black |
|---|-------|

LEDs

Bright LED

| | |
|----|-------|
| 5C | Red |
| 5D | Amber |
| 5F | Green |

Super Bright LED

| | |
|----|-------|
| 6B | White |
| 6F | Green |
| 6G | Blue |

Available with Square only

Cap Types & Colors

Full Face Illuminated Cap for Bright LED

Lens/Diffuser Colors

| | | | |
|-----|-------------|-----|-------------|
| CB | Red/White | FF | Green/Green |
| CC | Red/Red | *FJ | Green/Clear |
| *CJ | Red/Clear | JB | Clear/White |
| DB | Amber/White | JC | Clear/Red |
| DD | Amber/Amber | JD | Clear/Amber |
| *DJ | Amber/Clear | JF | Clear/Green |
| FB | Green/White | *JJ | Clear/Clear |

* Not available with Rectangular cap

Terminals

| | |
|-----|---|
| W01 | Silver Solder Lug* (for Snap-in Mounting) |
| W03 | Silver Straight PC (for PCB Mounting) |

Full Face Illuminated Cap for Super Bright LED

| | |
|----|---------------------------|
| JB | Clear Lens/White Diffuser |
|----|---------------------------|

For Square only; see cap detail page

Spot Illuminated Cap for Bright & Super Bright LEDs

| | |
|----|-------------------------|
| AB | Black with White Window |
|----|-------------------------|

Rectangular available for Bright only

* Wire harness & cable assemblies offered only in Americas

DESCRIPTION FOR TYPICAL ORDERING EXAMPLE

UB01KW035C-JC

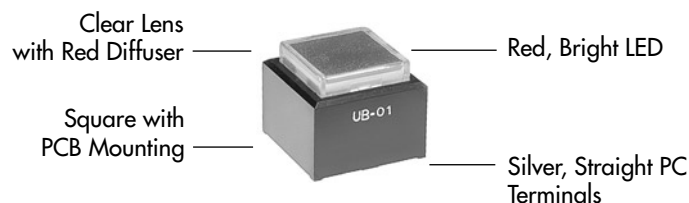

LED COLORS & SPECIFICATIONS

The electrical specifications shown are determined at a basic temperature of 25°C.
 If the source voltage exceeds the rated voltage, a ballast resistor is required.
 The resistor value can be calculated by using the formula in the Supplement section.

The LED is an integral part of the indicator and not available separately.

| | Color | Bright | | | Super Bright | | | Unit |
|-----------------------------------|--------------|--------------|------|------|--------------|------|------|-------|
| | | 5C | 5D | 5F | 6B | 6F | 6G | |
| Forward Peak Current | I_{FM} | 30 | 30 | 25 | 30 | 30 | 30 | mA |
| Continuous Forward Current | I_F | 20 | 20 | 20 | 20 | 20 | 20 | mA |
| Forward Voltage | V_F | 1.85 | 2.0 | 2.1 | 3.2 | 3.2 | 3.2 | V |
| Reverse Peak Voltage | V_{RM} | 5 | 5 | 5 | 5 | 5 | 5 | V |
| Current Reduction Rate Above 25°C | ΔI_F | 0.40 | 0.42 | 0.46 | 0.40 | 0.40 | 0.40 | mA/°C |
| Ambient Temperature Range | | -25° ~ +50°C | | | -25° ~ +50°C | | | |

Note for Super Bright:

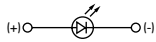

CAP TYPES & COLOR COMBINATIONS

Full Face Illuminated Cap for Bright LED

Lens/Diffuser

Colors Available for Square Cap:

- CB
- DJ
- JC
- CC
- FB
- JD
- CJ
- FF
- JF
- DB
- FJ
- JJ
- DD
- JB

AT4074
Lens

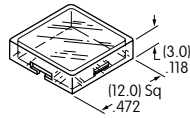

AT4075
Diffuser

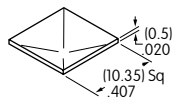

Lens & Diffuser Material: Polycarbonate

Lens/Diffuser

Colors Available for Rectangular Cap:

- CB
- FB
- JD
- CC
- FF
- JF
- DB
- JB
- DD
- JC

AT4117
Lens

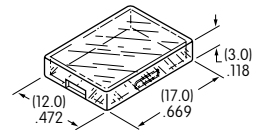

AT4118
Diffuser

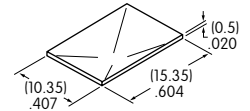

Diffuser Finish: Textured

Lens Finish: Glossy

Full Face Illuminated Cap for Super Bright LED

Lens/Diffuser

Colors Available for Square Cap:

- JB

AT4074 Lens & AT4075 Diffuser
(Dimensioned above)

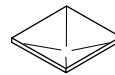
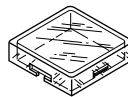

Lens & Diffuser Material: Polycarbonate

Lens Finish: Glossy

Rectangular lens & diffuser are not available for combining with super bright LED.

Diffuser Finish: Textured

Spot Illuminated Caps

- AB

Black Cap with Translucent White Window for LED Display

Material: Polycarbonate
Finish: Matte

AT4119 Square for Bright and Super Bright LED

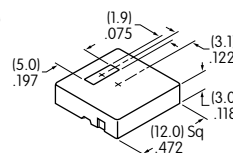

AT4120 Rectangular for Bright LED

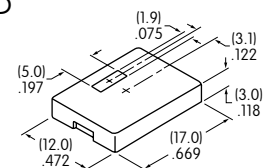

Color Codes:

A Black

B White

C Red

D Amber

F Green

J Clear

TYPICAL INDICATOR DIMENSIONS

Square • PCB Mount

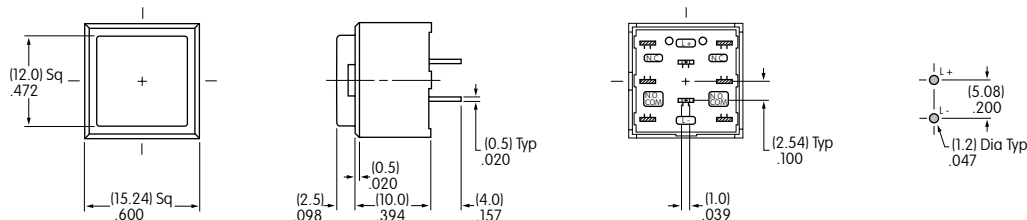

UB01KW035C-JC

Rectangular • PCB Mount

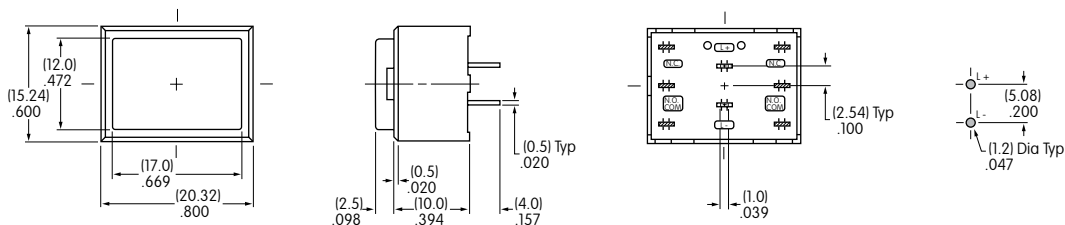

UB03KW035F-FF

Square • Snap-in Mount • Built-in Bezel

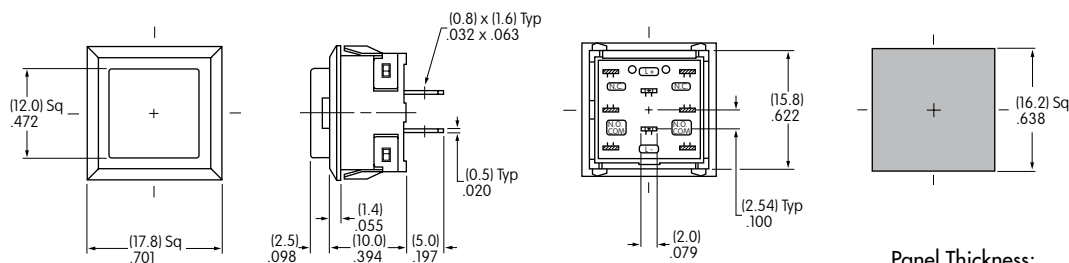

Panel Thickness:
1.0 ~ 3.2mm (.039 ~ .126")

UB04KW015C-JC

Rectangular • Snap-in Mount • Built-in Bezel

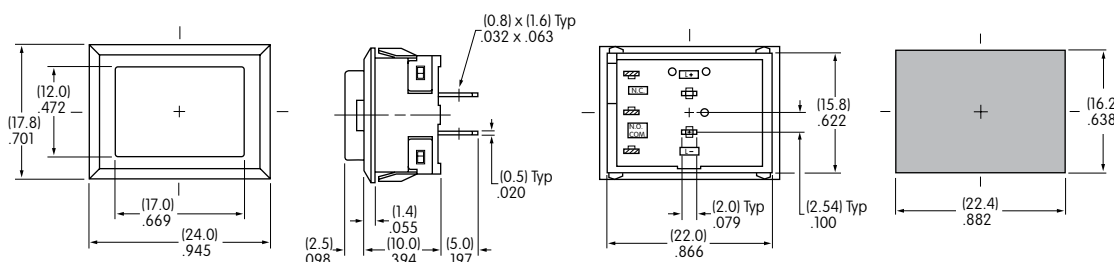

Panel Thickness:
1.0 ~ 3.2mm (.039 ~ .126")

UB06KW015D-DD

Rectangular • Snap-in Mount • Built-in Side Barriers

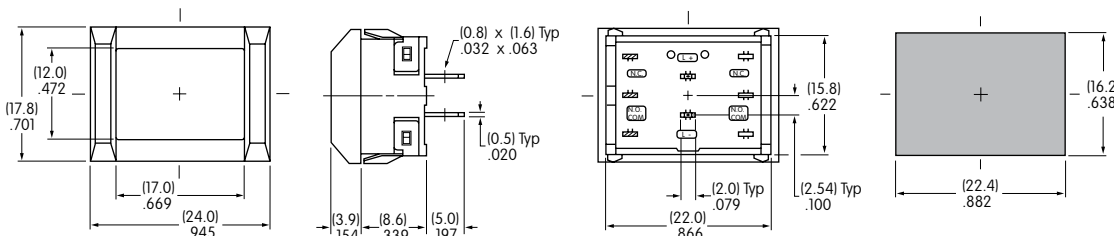

Panel Thickness:
1.0 ~ 3.2mm (.039 ~ .126")

UB06BKW015F-FF